

Lab Instructions

PHYTO EXTRACTION METHOD

- 1** •Check Expiry Date
•Check Desiccant Pouch:
Blue = OK
Pink = Do not use test



- 2** Place 400 μ L of buffer in a vial.

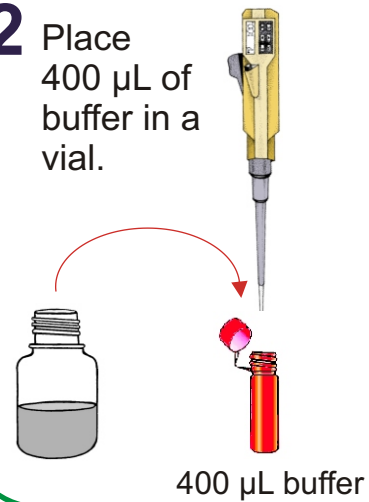

- 3** Add 100 μ L of phyto extract to the vial in step 2.

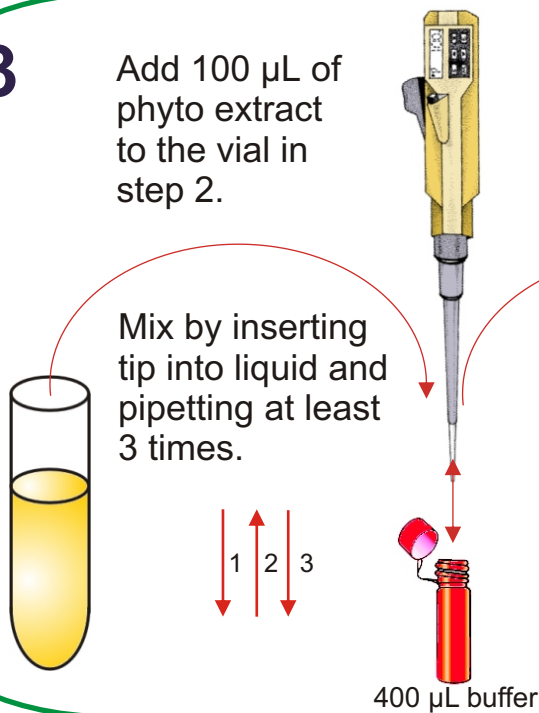

- 4** Place 100 μ L of the mixture into sample well "S".

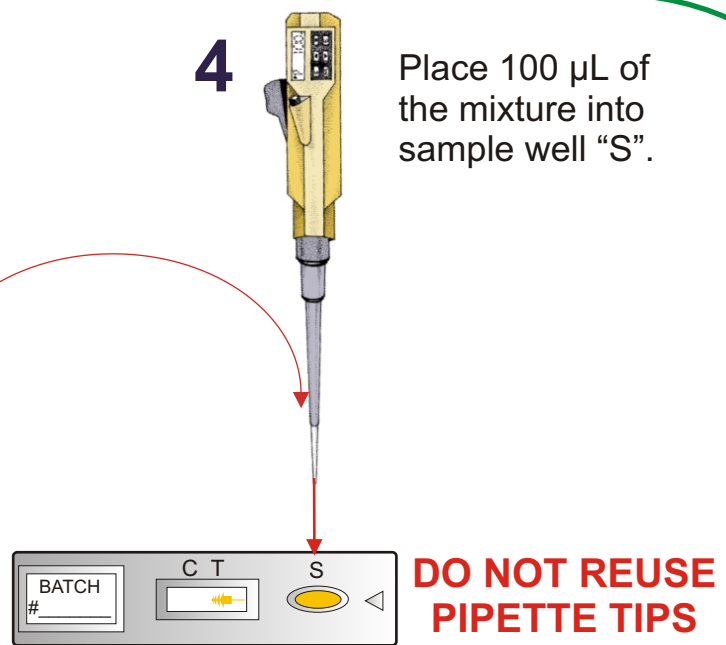

5

Read your results between 45-75 minutes.
Turn this page for C & T Line Interpretation.

